

P1

T1

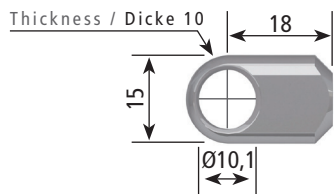

P2

T2

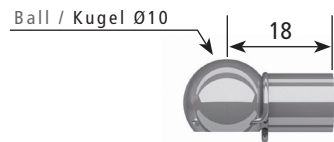

P3

T3

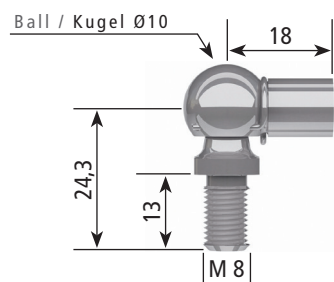
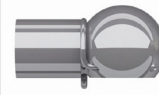

P4

T4

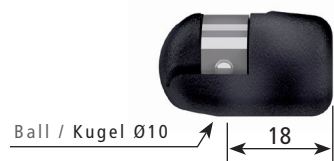

P5

T5

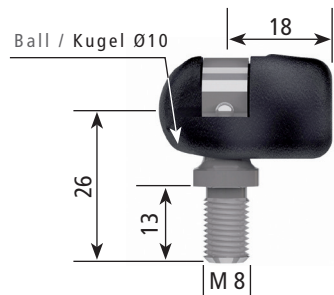

P6

T6



| A | | B | |
|------------|---------------------------------|-----------------------|----------------------|
| Stroke Hub | Extended length Ausgesch. Länge | Force Kraft F_1 [N] | Ref.-No. Bestell-Nr. |
| 60 | 169 | * | 9049RH |
| 80 | 209 | * | 9051RO |
| 100 | 249 | * | 9052RJ |
| 120 | 289 | * | 9053RE |
| 140 | 329 | * | 9055RV |
| 160 | 369 | * | 9056RQ |
| 180 | 409 | * | 9057RL |
| 200 | 449 | * | 9058RG |
| 220 | 489 | * | 9059RB |
| 250 | 549 | * | 9061RI |

* F_1 - Values from 100 - 600 N, in steps of 25 N
 * F_1 - Werte von 100 - 600 N, gestaffelt in 25 N-Schritten

Ordering example / Bestell-Beispiel

| | | | |
|--------------------------|-------|---|--|
| 123456 / 0350N / P2 / T1 | | | |
| Ref.-No. Bestell-Nr. | F_1 | Piston rod end fitting Kolbenstangen-Anschluss | Pressure tube end fitting Druckrohr-Anschluss |

Installation according to STAB-Spec. 10022248
 Montage nach STAB-Spec. 10022248

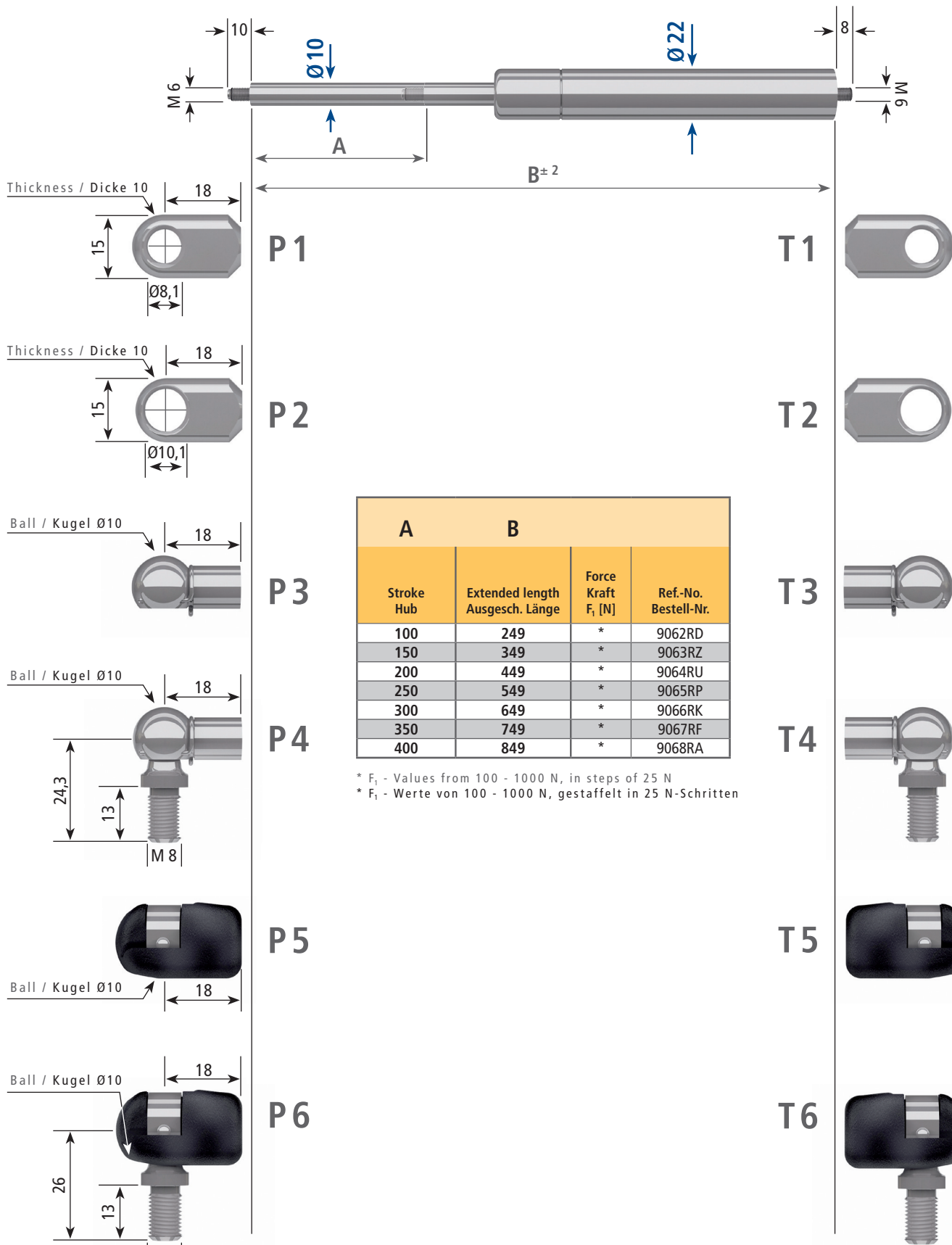

| | | B | |
|---------------|------------------------------------|--------------------------------------|-------------------------|
| A | B | Force Kraft F ₁ [N] | Ref.-No. Bestell-Nr. |
| Stroke Hub | Extended length Ausgesch. Länge | | |
| 100 | 249 | * | 9062RD |
| 150 | 349 | * | 9063RZ |
| 200 | 449 | * | 9064RU |
| 250 | 549 | * | 9065RP |
| 300 | 649 | * | 9066RK |
| 350 | 749 | * | 9067RF |
| 400 | 849 | * | 9068RA |

* F₁ - Values from 100 - 1000 N, in steps of 25 N
 * F₁ - Werte von 100 - 1000 N, gestaffelt in 25 N-Schritten

| Ordering example / Bestell-Beispiel | | | | | | |
|-------------------------------------|----------------|---|---|--|---|----|
| 123456 | / | 0350N | / | P2 | / | T1 |
| Ref.-No. Bestell-Nr. | F ₁ | Piston rod end fitting Kolbenstangen-Anschluss | | Pressure tube end fitting Druckrohr-Anschluss | | |

Installation according to STAB-Spec. 10022260
 Montage nach STAB-Spec. 10022260

We reserve the right to make modifications. Dimensions in mm.
 Änderungen vorbehalten. Maßangaben in mm.